



# DIY iFan04

User manual V1.0



## Wi-Fi Smart Ceiling Fan with Light Controller

## 产品介绍

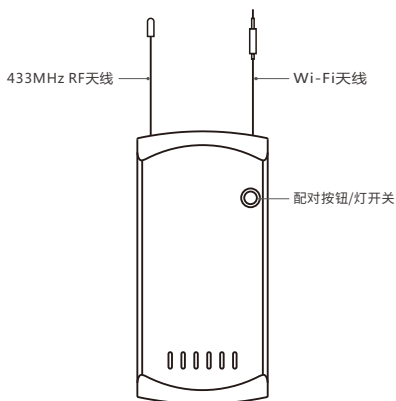

⚠ 设备重量<1kg, 建议安装高度<2米。

## 产品特点

本设备为一款风扇灯控制器, 风扇灯通过与本设备相连可在易微联App 端分别控制灯、风扇的开关, 风速控制, 设置定时开/关和分享给您的家人一起控制等等。



远程控制



智能定时/延时



语音控制



分享功能



风速控制



智能场景



同步状态



433MHz 遥控控制



局域网控制



创建群组

## 使用说明

### 1. 断电

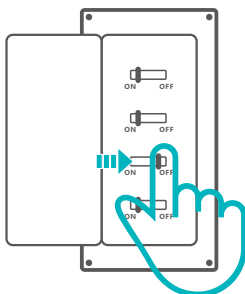

⚠ 设备安装、故障维修请由专业资质电工操作。切勿在设备通电时进行接线操作, 以免发生触电危险!

## 2. 接线

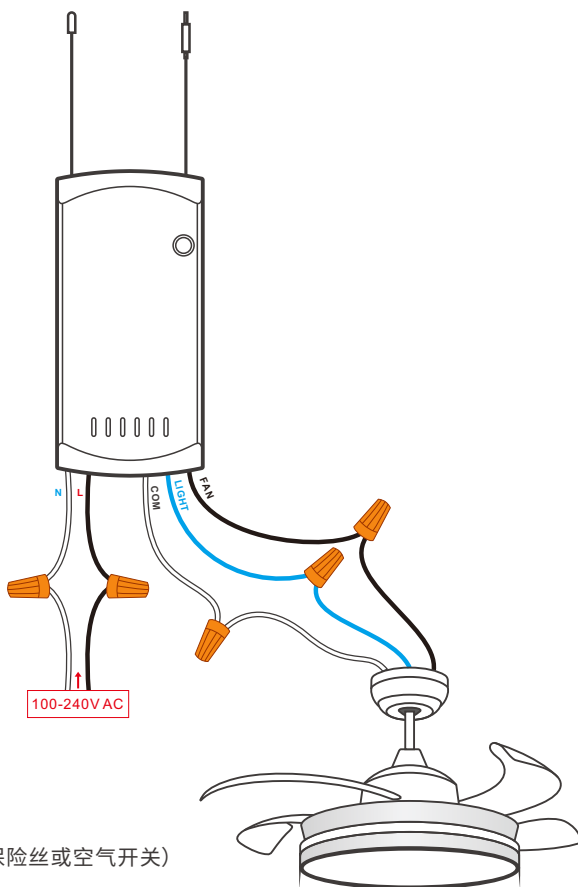

- ⚠ L 端输入前需接保护装置 (如: 保险丝或空气开关)
- ⚠ 确保线接入无误。

## 3. 下载“易微联”App



Android™ & iOS

## 4. 上电

通电后,设备首次使用,默认进入快速配网模式。设备蜂鸣器呈两短一长响声。

Ⓢ 三分钟内没有进行配网,设备将退出快速模式。如需再次进入,长按设备配对按钮5秒或将设备连续上电3次(开-关-开-关-开)直到设备蜂鸣器呈两短一长响声即可。

## 5. 添加设备

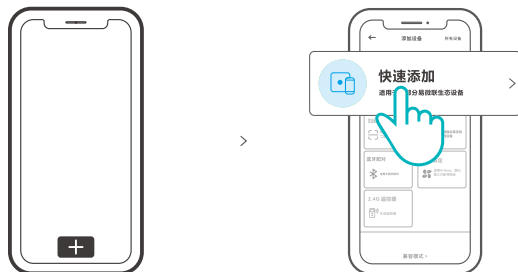

点击“+”,选择“快速添加”,再根据 App 提示进行操作。

## 兼容配网模式

如使用快速添加模式配网失败,请使用“兼容配网模式”进行配对。

- ① 长按设备配对按钮5秒直到设备蜂鸣器呈“两短一长”响声,松开。再次长按配对按钮5秒直到设备蜂鸣呈“快响”状态(滴滴滴滴.....),此时设备进入兼容配网模式。
- ② 在App界面,点击“+”,选择“兼容模式”。

输入Wi-Fi密码,点击“下一步”再点击“去连接”,将移动设备连接上Wi-Fi账号为:ITEAD-\*\*\*\*\*,密码为:12345678,然后回到“易微联”App,点击“下一步”,等待配对完成。

Ⓢ 设备连续上电5次(开-关-开-关-开-关-开-关-开)也可进入“兼容配网模式”

## 取出遥控器绝缘片

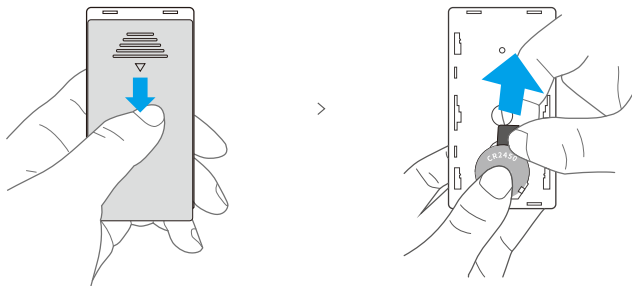

出厂时,RM433R2遥控器已与 iFan04 进行绑定,取出遥控器电池绝缘片之后即可进行控制,如不能控制,请尝试重新学习。

## 设备与RM433R2遥控器的学习方法：

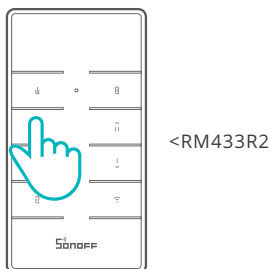

在设备上电后的5秒内长按遥控器任意按键至设备蜂鸣器“滴”一声，即全部按键学习成功，如5秒内未进行下一步操作，请重新上电。

⚠ 设备最多配对10遥控器，超过10个则会自动覆盖第一个学习的遥控器，以此类推。

## 产品参数

型号	iFan04-L, iFan04-H
输入	100-240V AC 50/60Hz 5A
输出	<p><b>iFan04-L:</b>            灯具: 100-240V AC 50/60Hz 3A Max            钨丝灯: 360W/120V Max    LED: 150W/120V Max            风扇: 100-240V AC 50/60Hz 2A Max</p> <p><b>iFan04-H:</b>            灯具: 100-240V AC 50/60Hz 3A Max            钨丝灯: 690W/230V Max    LED: 300W/230V Max            风扇: 100-240V AC 50/60Hz 2A Max</p>
RF	433MHz
Wi-Fi	IEEE 802.11 b/g/n 2.4GHz
App 支持系统	Android & iOS
工作温度	-10°C~40°C
外壳材料	PC V0
产品规格	116x55x26mm

## 更换设备网络

在 eWeLink App 设备设置界面选择“WiFi设置”进行更换。

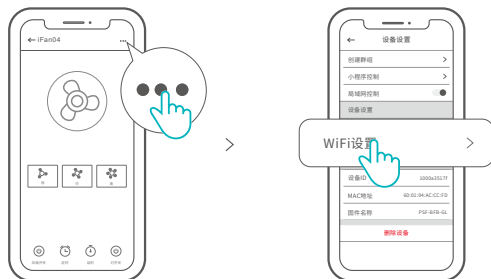

## 重新配对

### 方法1:

长按设备“配对按钮”5秒直到设备蜂鸣器呈两短一长响声，松开，此时设备进入快速配网模式，即可再次通过 eWeLink App 进行添加。

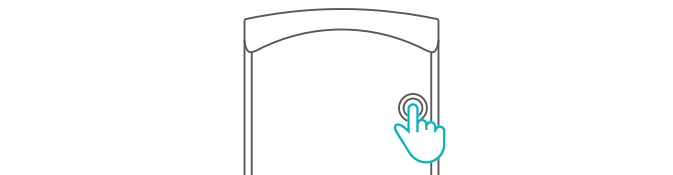

### 方法2:

长按RM433R2遥控器配对按钮5秒直到设备蜂鸣器呈两短一长响声，松开，此时设备进入快速配网模式，即可再次通过 eWeLink App 进行添加。

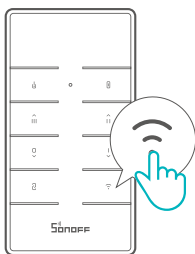

### 方法3:

将设备连续上电3次(开-关-开-关-开),直到设备蜂鸣器呈两短一长响声,松开,此时设备进入快速配网模式,即可再次通过 eWeLink App 进行添加。

⚠️ 配网模式下,短按遥控器任意按键可退出当前模式。

## 恢复出厂设置

在 eWeLink App 端“删除设备”，设备即恢复出厂设置。

## 遥控器参数

型号	RM433R2
RF	433MHz
遥控器尺寸	87x45x12mm
遥控器底座尺寸	86x86x15mm(可选)
供电	3V纽扣电池 x 1 (电池型号:CR2450)
外壳材料	PC V0

## 遥控器介绍

iFan04支持使用RM433R2遥控器进行控制,学习成功后,即可根据下图按键说明控制设备,此功能属于本地近程无线遥控与Wi-Fi网络无关。

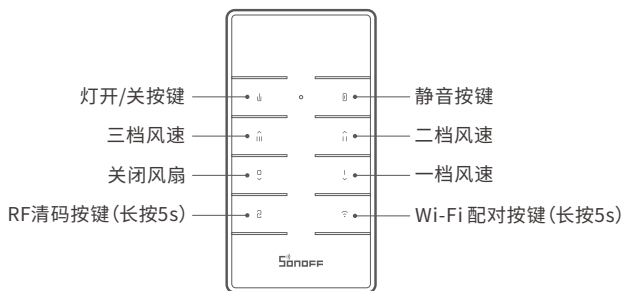

**RF清码方法:** 长按RF清码按键5秒至设备蜂鸣器发出“滴 滴”两声,即完成清码。

出厂默认设备的蜂鸣器会在开/关风扇、调节风扇档位、设备处于配对模式时发出声音作为操作提示,在开关灯时不会响。如果需要关闭蜂鸣器声音,请通过配对的 433 遥控器短按“静音”按钮关闭。

## 常见问题

### Wi-Fi设备与 eWeLink APP 配对失败。

1. 确保设备处于配对模式。三分钟内没进行配网,设备将自动退出配对模式。
2. 请开启定位服务并允许定位权限。在选择Wi-Fi网络之前,请开启定位服务并允许定位权限。位置信息权限用于获取Wi-Fi列表信息。如果单击禁用,您将无法添加设备。
3. 确保您的Wi-Fi网络为2.4GHz频段。
4. 确保您输入了正确的Wi-Fi SSID和密码,没有包含特殊字符。密码错误是配对失败的一个非常常见的原因。
5. 配对时设备应靠近路由器,以保证良好的传输信号条件。

## Product Introduction

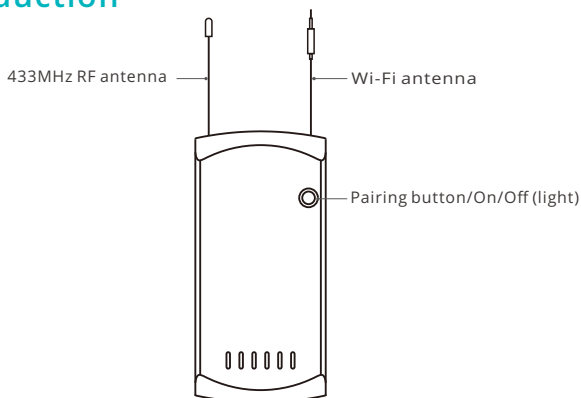

⚠ The device weight is less than 1 kg. The installation height of less than 2 m is recommended.

## Features

This is a Wi-Fi smart controller for the ceiling fan with light that allows you to remotely turn on/off the fan and light separately, adjust the fan speed, schedule it on/off and share it with your families to control together, etc. on the eWeLink App.



Remote Control



Single/Countdown  
Timing



Voice Control



Share Control



Fan Speed Adjustment



Smart Scene



Sync Status



433MHz Remote  
Control



LAN Control



Group Control

## Operating Instruction

### 1. Power off

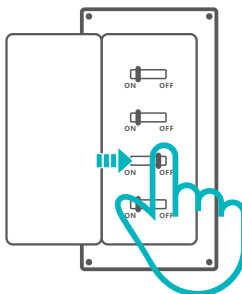

⚠ Please install and maintain the device by a professional electrician. To avoid electric shock hazard, do not operate any connection while the device is powered on!



## 2. Wiring instruction

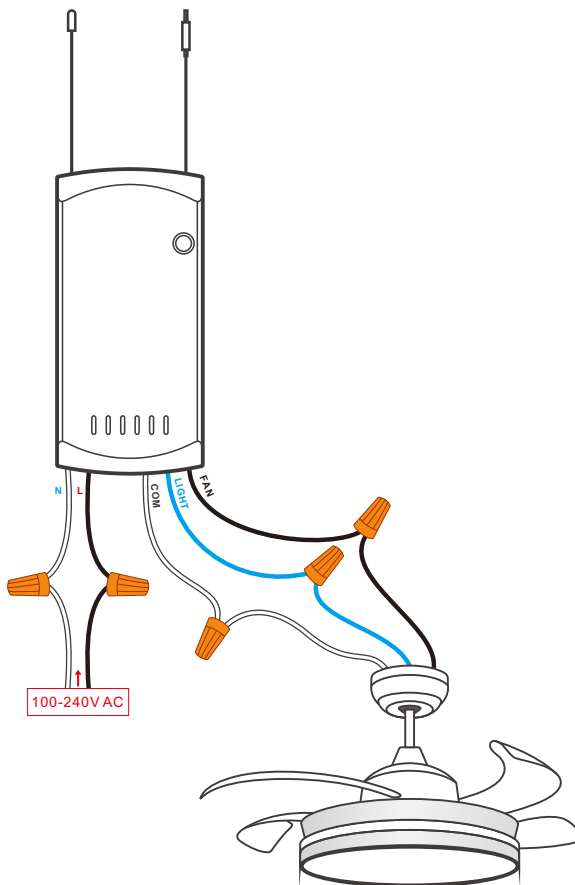

- ⚠ Please install protection devices before connecting the live wire. (e.g. fuses or air switches).
- ⚠ Make sure all wires are connected correctly.

## 3. Download the eWeLink APP



Android™ & iOS

## 4. Power on

After powering on, the device will enter the quick pairing mode during the first use, then the device makes two short beeps and one long beep.

- ⓘ The device will exit the quick pairing mode if not be paired within 3mins. If you want to enter the quick pairing mode again, press and hold the pairing button for 5s, or keep turning the device on and off repeatedly for 3 times (on-off-on-off-on) until the buzzer makes two short beeps and one long beep.

## 5. Add the device

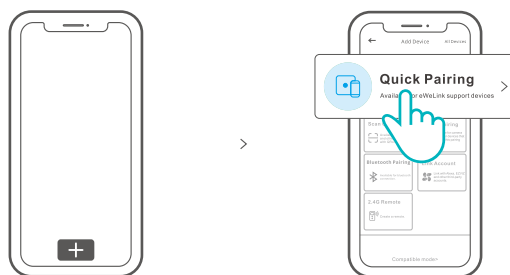

Tap "+" and select "Quick Pairing", then operate following the prompt on the App.

## Compatible Pairing Mode

If you fail to enter Quick Pairing Mode, please try "Compatible Pairing Mode" to pair.

- ① Press and hold the pairing button for 5s until the buzzer makes two short beeps and one long beep then release. Press the pairing button for 5s again until the buzzer makes a high frequency of beeps, which means the device has entered "compatible pairing mode".

- ② Tap "+" and select "Compatible Pairing Mode" on App.

Select Wi-Fi SSID with ITEAD-\*\*\*\*\* and enter the password 12345678, and then go back to eWeLink App and tap "Next". Be patient until pairing completes.

- ⓘ Keep turning the device on and off repeatedly for 5 times (on-off-on-off-on-off-on-off-on) to enter "compatible pairing mode".

## Remove the Battery Insulation Sheet

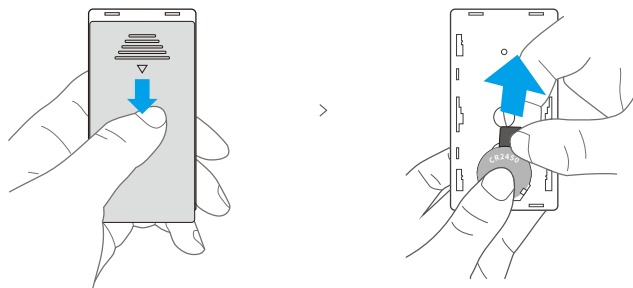

After factory setting, RM433R2 remote controller is bound to iFan04 by default. Simply remove the battery insulation sheet to use. If the device connected to iFan04 is not controlled by the remote controller, try to learn the remote controller again.

## Learning Method for iFan04 and RM433R2 Remote Controller

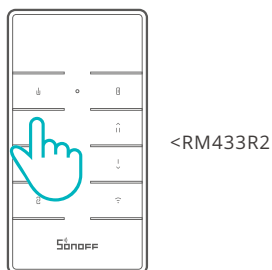

After powering on iFan04, press any button on the controller until the buzzer makes a "beep" sound within 5s, then all the buttons are learned successfully. If you do not operate any step within 5s, power the device on again and repeat the above operation.

⚠ This device can learn up to 10 remote controllers. The 11th remote controller will automatically cover the first learned one, and so on.

## Specifications

Model	iFan04-L, iFan04-H
Input	100-240V AC 50/60Hz 5A
Output	<p><b>iFan04-L:</b>                      Light: 100-240V AC 50/60Hz 3A Max                      Tungsten lamp: 360W/120V Max      LED: 150W/120V Max                      Fan: 100-240V AC 50/60Hz 2A Max</p> <p><b>iFan04-H:</b>                      Light: 100-240V AC 50/60Hz 3A Max                      Tungsten lamp: 690W/230V Max      LED: 300W/230V Max                      Fan: 100-240V AC 50/60Hz 2A Max</p>
RF	433MHz
Wi-Fi	IEEE 802.11 b/g/n 2.4GHz
App operating systems	Android & iOS
Working temperature	-10°C~40°C
Material	PC V0
Dimension	116x55x26mm

## Switch Network

Select the "Wi-Fi Settings" in the "Device Settings" interface on the eWeLink App to change.



## Re-establish Pairing

### Method 1:

Press the "pairing button" on the device for 5s until the buzzer makes two short beeps and one long beep then release, which means the device has entered quick pairing mode, so it can be added in the eWeLink App again.

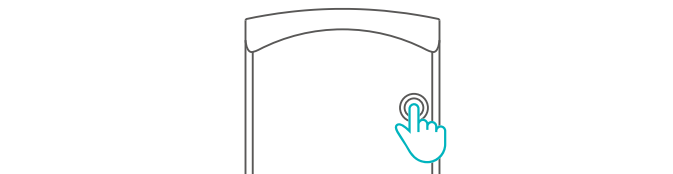

### Method 2:

Press the "pairing button" on RM433R2 remote controller for 5s until the buzzer makes two short beeps and one long beep then release, which means the device has entered quick pairing mode, so it can be added in the eWeLink App again.

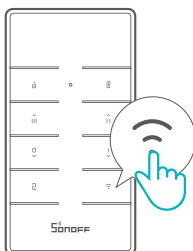

### Method 3:

Keep turning the device on and off repeatedly for 3 times (on-off-on-off-on) until the buzzer makes two short beeps and one long beep then release, which means the device has entered quick pairing mode, so it can be added in the eWeLink App again.

⚠ In quick pairing mode, press any button on the remote controller to exit the current mode.

## Factory Reset

Deleting the device on the eWeLink APP indicates you restore it to factory setting.

## Remote Controller Specifications

Model	RM433R2
RF	433MHz
Remote controller size	87x45x12mm
Remote controller base size	86x86x15mm (not included)
Power supply	3V button cell x 1 (Battery model: CR2450)
Material	PC V0

## Remote Controller Introduction

iFan04 can be controlled by RM433R2 remote controller. After learning is successful, you can control the device connected with iFan04 according to the button instruction below. This feature is referred to as a short-distance wireless communication, unrelated to Wi-Fi network communication.

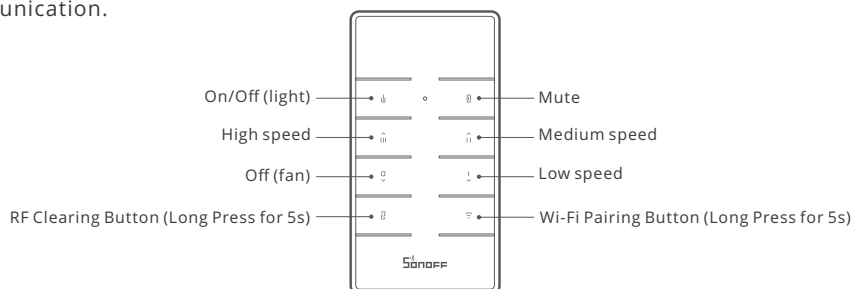

### RF Clearing Method:

Press and hold the RF clearing button for 5s the buzzer makes "beep, beep" sound after clearing is successful.

The buzzer of iFan04 in factory default setting will indicate you with the "beep" sound when you turn on/off the fan, adjust the fan speed, and the device enters pairing mode, but no a "beep" sound is made when you turn on/off the light. You can press the "Mute" button on the paired RM433R2 remote controller to silence the buzzer.

## Common Problems

### Fail to pair Wi-Fi devices to eWeLink APP

1. Make sure the device is in pairing mode. After three minutes of unsuccessful pairing, the device will automatically exit pairing mode.
2. Please turn on location services and allow location permission. Before choosing the Wi-Fi network, location services should be turned on and location permission should be allowed. Location information permission is used to obtain Wi-Fi list information. If you click Disable, you will not be able to add devices.
3. Make sure your Wi-Fi network runs on the 2.4GHz band.
4. Make sure you entered a correct Wi-Fi SSID and password, no special characters contained. Wrong password is a very common reason for pairing failure.
5. The device shall get close to the router for a good transmission signal condition while pairing.

## FCC Warning

Changes or modifications not expressly approved by the party responsible for compliance could avoid the user's authority to operate the equipment.

This device complies with part 15 of the FCC Rules. Operation is subject to the following two conditions: (1) This device may not cause harmful interference, and (2) this device must accept any interference received, including interference that may cause undesired operation.

### **FCC Radiation Exposure Statement:**

This equipment complies with FCC radiation exposure limits set forth for an uncontrolled environment. This equipment should be installed and operated with minimum distance 20cm between the radiator & your body. This transmitter must not be co-located or operating in conjunction with any other antenna or transmitter.

### **Note:**

This equipment has been tested and found to comply with the limits for a Class B digital device, pursuant to part 15 of the FCC Rules. These limits are designed to provide reasonable protection against harmful interference in a residential installation. This equipment generates, uses and can radiate radio frequency energy and, if not installed and used in accordance with the instructions, may cause harmful interference to radio communications. However, there is no guarantee that interference will not occur in a particular installation. If this equipment does cause harmful interference to radio or television reception, which can be determined by turning the equipment off and on, the user is encouraged to try to correct the interference by one or more of the following measures:

- Reorient or relocate the receiving antenna.
- Increase the separation between the equipment and receiver.
- Connect the equipment into an outlet on a circuit different from that to which the receiver is connected.
- Consult the dealer or an experienced radio/TV technician for help.

Hereby, Shenzhen Sonoff Technologies Co., Ltd. declares that the radio equipment type iFan04-L, iFan04-H is in compliance with Directive 2014/53/EU. The full text of the EU declaration of conformity is available at the following internet address:

<https://sonoff.tech/usermanuals>



**Shenzhen Sonoff Technologies Co., Ltd.**

1001, BLDG8, Lianhua Industrial Park, shenzhen, GD, China  
ZIP code: 518000 Website: sonoff.tech

MADE IN CHINA

